

Connecting the iPad to su-pirate iOS v. 3 and above

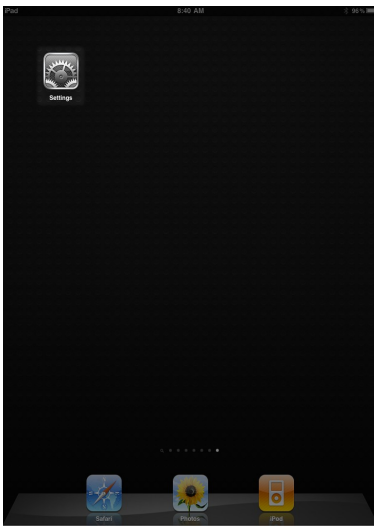

1. Tap **Settings** from your home screen.

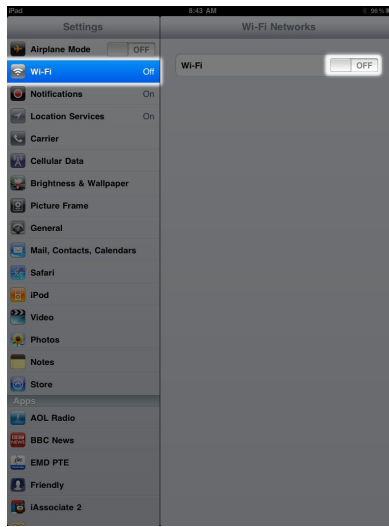

2. Tap **Wi-Fi**.
3. If your Wi-Fi is OFF, slide the switch to the right to **turn Wi-Fi on**.

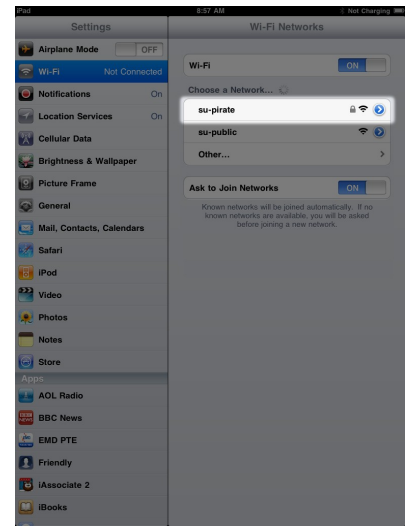

4. In the list of networks that appears, tap **su-pirate**.

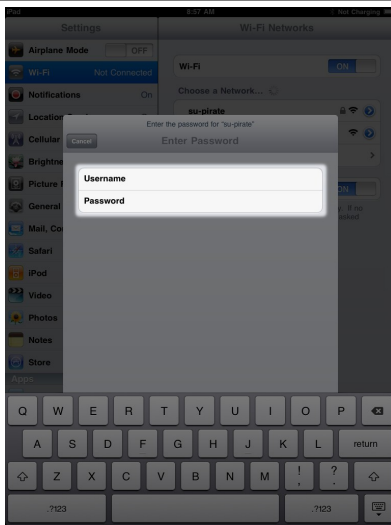

5. Enter your SUEID in the **Username** box, and your SUEID password in the **Password** box.

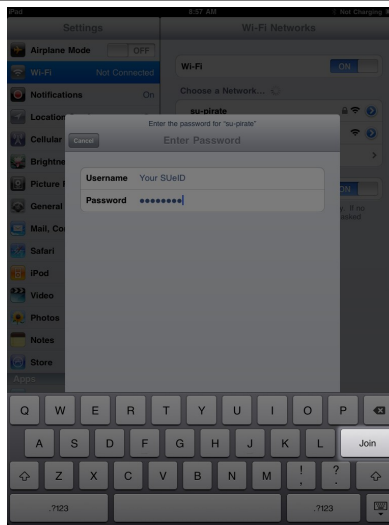

6. Press the **Join** button. If you do not see the button, ensure that you entered your SUEID and password as detailed in the previous step. Wait a few seconds as your identity is verified.
Note: a Certificate screen may appear. If this happens, tap the **Accept** button.

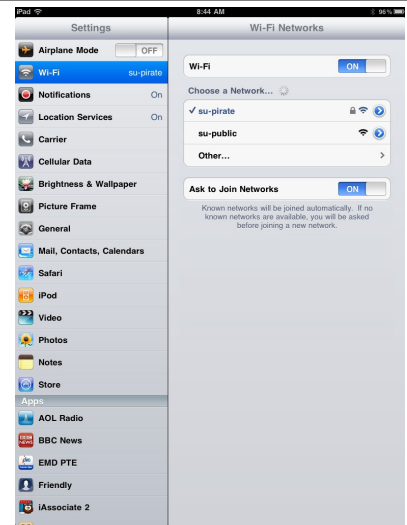

7. Wait a few more seconds and once you are connected, a check mark will appear next to **su-pirate** on the **Wi-Fi Networks** page indicating that you are connected to su-pirate.

If you are not able to connect to the pirate network after completing all of these steps, please contact the Help Desk at x7333 [512-819-7333] or helpdeskX@southwestern.edu